

Drum dryer R ... TT

Drying and polishing of cup-shaped or flat components with drying agent to give immaculate, shiny surfaces

This range of machines is normally used for drying large, mass produced components, the rotary scroll is filled with drying media (Supervelat), the components are loaded into the entry point of the machine, either continuously or in batches. In the drying section of the scroll the components are permanently covered by the drying media, the drying media (Supervelat) is heated via a heating system at the base of the machine, this ensures complete

evaporation of any liquids and maintains the optimum condition of the drying media. Special tumbling profiles are strategically fixed to the inside of the scroll ensuring the continuous transport of components through the drying section to the separation section. At the separation section the components are automatically discharged from the machine, while the Supervelat is returned and re-used in the drying section.

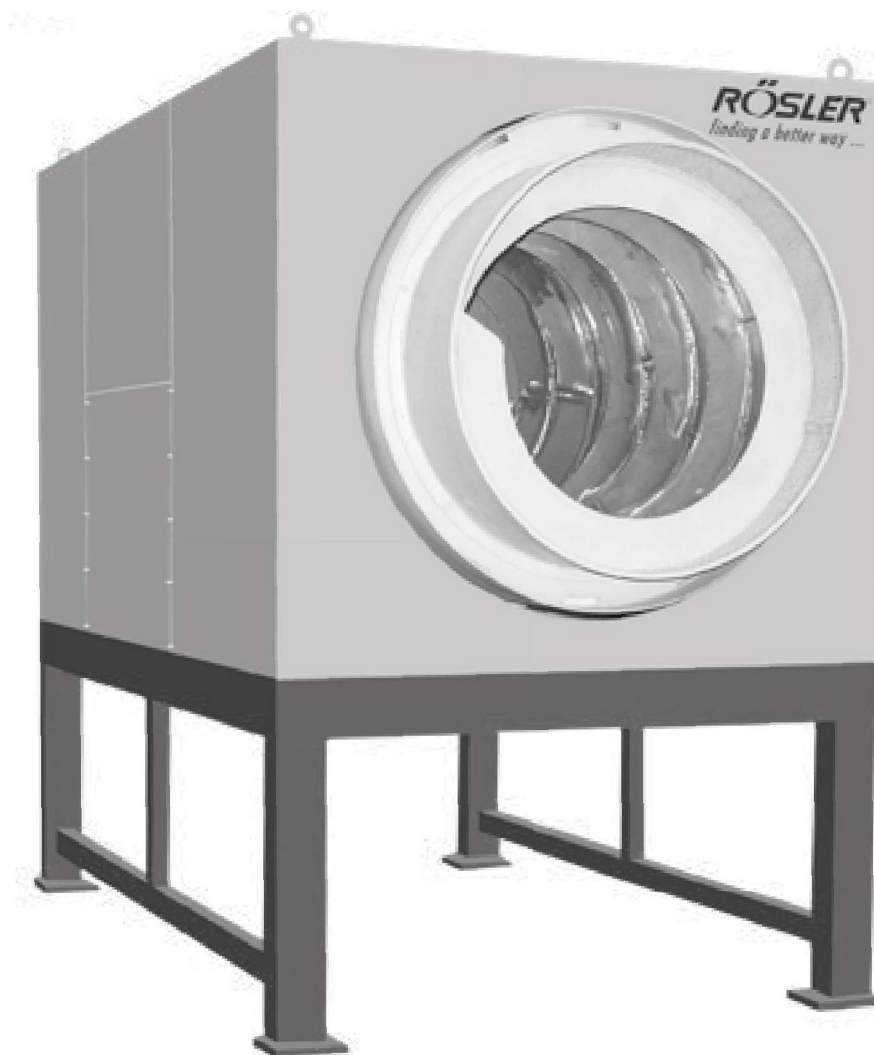

High performance machine for drying and polishing cup-shaped or flat components which would drag out drying agent or cover the separation sieve in rotary dryers.

Special

1

Large drum dimensions

and large volume to accommodate large component batches produce high output.

2

Constant turning

of the components in the large volume dryer drum ensures rapid drying.

3

Energy-saving

as a result of the highly efficient way heat is transferred from the easily accessible, thermostatically controlled heating elements to the workpieces and the drying agent. Drumhousing completely isolated.

4

Drying times

can be varied by easily adjustable control wheel. Drumspeed control possible.

5

Automatic separation

of components and drying agent by large, integral, replaceable sieve drum with automatic drying agent return.

6

Easy change drying media

by reversing drum rotation.

Specifications Drum dryer R ... TT

Standard types	R 2002 TT	R 3002 TT	R 5000 TT
External dimensions			
A - Belt length (mm)	2.900	3.890	3.630
A ₁ - length of drying tunnel (mm)	2.200	3.190	2.880
B - (mm)	1.340	1.360	1.600
C - (mm)	1.415	1.415	1.735
D - (mm)	1.006	1.006	1.280
E * ¹ - (mm)	1.080	1.080	1.110
F * ¹ - (mm)	380	380	380
G - (mm)	400	400	400
H - (mm)	300	300	370
J - (mm)	690	690	690
Dimensions of the drying drum			
Overall length (mm)	2.272	3.270	2.520
External diameter (mm)	1.006	1.006	1.280
Length of drying compartment (mm)	1.300	2.260	1.530
Diameter of drying compartment (mm)	795	795	1.077
Volume of drying compartment (l)	655	1.160	1.510
K - Diameter of filling aperture (mm)	320	320	450
Length of sieve drum (mm)	1.120	1.130	1.000
Diameter of sieve drum (mm)	800	800	1.105
Sieve drum perforation, standard (mm)	5	5	5
Heating power (kW)	13,5	27	27
Drum speed * ² (Upm)	4,0	4,0	4,0

*¹ measurements can be adapted to customer's wishes

State: 08/2011

*² optional, infinitely variable speed

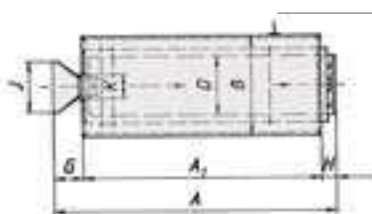

standard sieve basket perforation
5 mm or to suit customer's needs

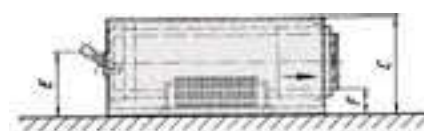

adjustable metering disc